

PERMIT

City of Napoleon  
255 W. Riverview  
Napoleon, OH 43545

Division of Building and Zoning  
PH (419) 592-4010  
FAX (419) 599-8393

Permit No: 001954

Date Issued: 11-19-03

Issued by: BND

Job Location: 1164 CHELSEA AVE

Est. Cost: 142882.00

Lot #: B

Subdivision Name: G&H 4TH REPLAT

Owner: MCCOLLEY, JAMES  
Address: KAHLE DESIGN & BLD  
CSZ: 1164 CHELSEA AVE  
Phone: 13107

Agent:  
Address: BU  
CSZ: 14288200 001954  
Phone:

Use Type - Residential:

Other:

ZONING INFORMATION

Dist: R-4 Lot Dim: Area: 9242  
Max HT: 45 # Pkg Spaces: 2

Fyrd: 25 Syrd: 0 Ryrd: 15  
# Loading SP: Max Lot Cov: 45%

BOARD OF ZONING APPEALS:

Work Type - New: X Replmnt: Addn'n: Alter: Remodel:

WORK INFORMATION

Size - Lgth: 55 Width: 46 Stories: 1 Living Area SF: 1541  
Garage Area SF: 410 Height: 20 Bldg Vol Demo Permit:

WORK DESCRIPTION

BU  
27100

FEE DESCRIPTION	PAID DATE	FEE AMOUNT DUE
BUILDING PERMIT		271.00
ELECTRICAL PERMIT		85.00
PLUMBING PERMIT		39.00
MECHANICAL PERMIT		26.00
WATER TAP PERMIT		655.00
SEWER PERMIT		172.00

Total Fees Due 1248.00

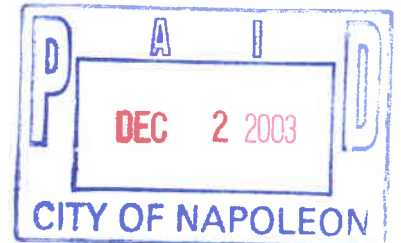

12/2/03

Date

*Denise Kala*

Applicant Signature



City of Napoleon Inspection Form

Permit #001954

Date Issued: 11-19-2003

Job Location: 1164 CHELSEA AVE

Owner: MCCOLLEY, JAMES

Owner Phone: 419-592-5248

Contractor: KAHLE DESIGN & BLD

Contractor Phone: 419-497-4805

Work Description: NEW HOME

Plumbing: UNDGR \_\_\_\_\_ RGHIN 5-27 FINAL 9-24-04

SEWER INSP 4-5-04

Mechanical: UNDGR \_\_\_\_\_ RGHIN 6-30 FINAL 9-24-04

FURNACE REPLAC \_\_\_\_\_ AIR COND \_\_\_\_\_

Electrical: UNDGR \_\_\_\_\_ RGHIN 6-3 FINAL 9-24-04

SEVR UPGR \_\_\_\_\_

Building: Site 11-20 FTG 11-20 FNDDT 4-5

STRU 6-3 ROOF 6-3 EXT 9-17

VENT 9-17 ACCES 9-17 EGRS 9-17

SMKDT \_\_\_\_\_ FINAL \_\_\_\_\_

ISSUE TEMP OCCUP \_\_\_\_\_ ISSUE OCCUP 9-24-04

STGE Shed: SITE \_\_\_\_\_ FINAL \_\_\_\_\_

Sign: FTG \_\_\_\_\_ FINAL \_\_\_\_\_

Fence: SITE \_\_\_\_\_ FINAL \_\_\_\_\_

MISC INSP: 6 org floor 4-10-04

NOTES:

NOT LICENSED FOR THIS TYPE OF WORK - JOB APPROVALS CORRECT

INSPECTORS INITIALS: SRK



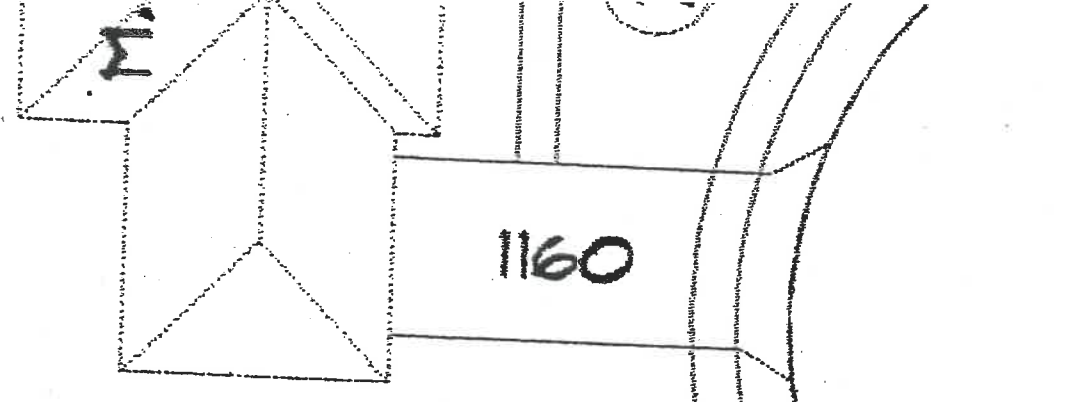

1160

Common Lawn

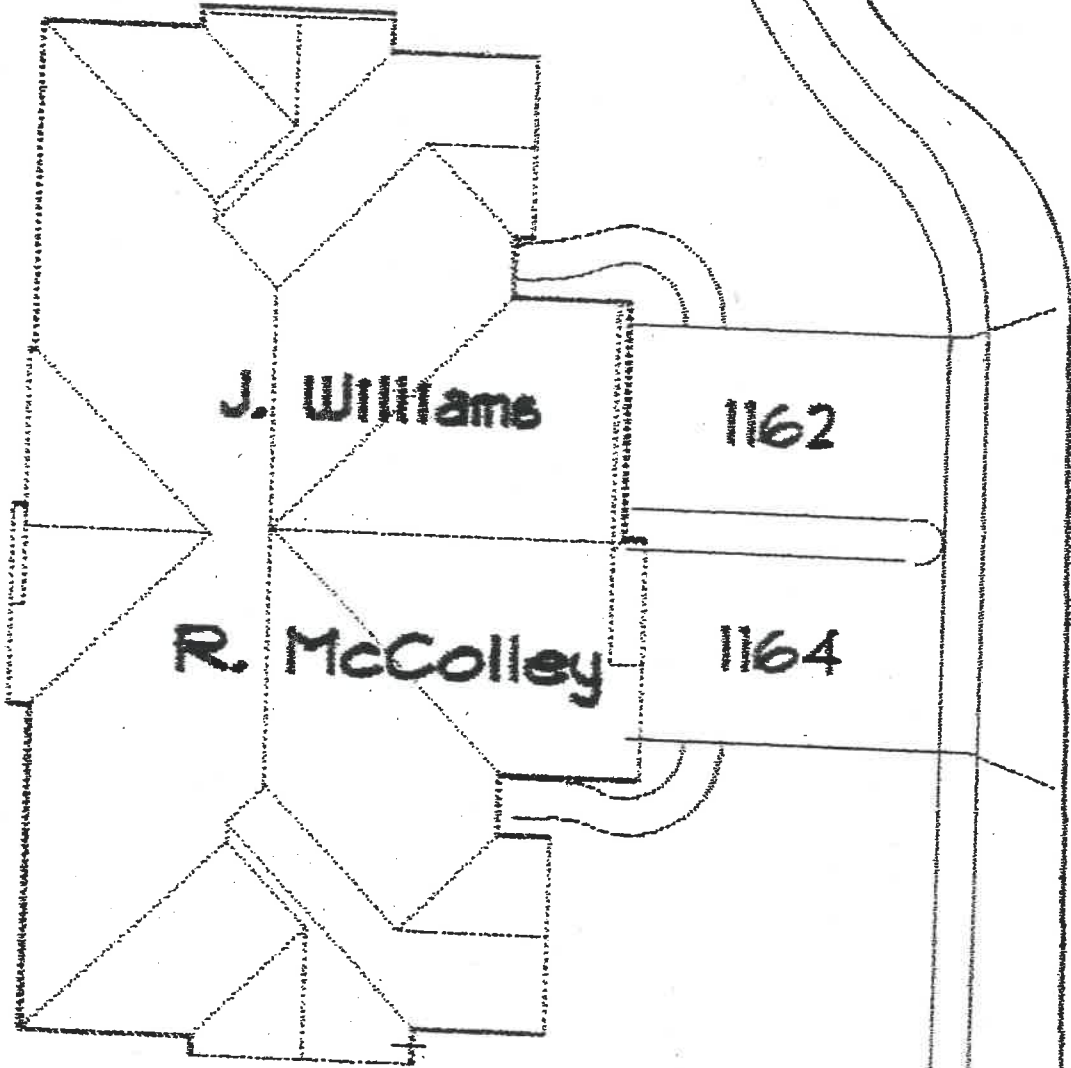

J. Williams

1162

R. McColley

1164

L

Common Lawn

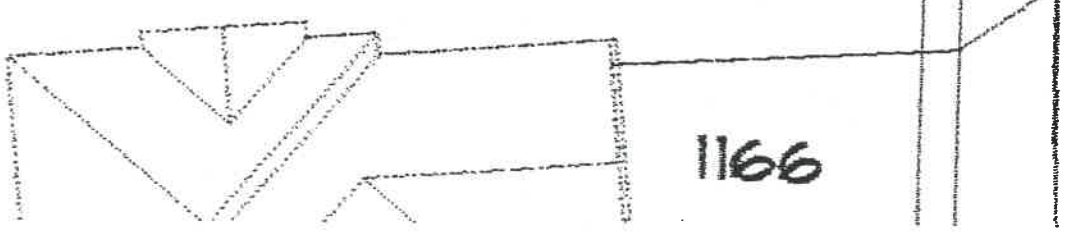

1166

Chelsea



**APPLICATION FOR**  
**Residential, Building, Electrical, Plumbing, Mechanical, and Demolition Permit**  
**FROM - The City of Napoleon, Ohio, Building Department**  
 255 West Riverview Avenue; P.O. Box 151; Napoleon, Ohio 43545 - Telephone (419) 592-4010

ENTRY NO. \_\_\_\_\_

PERMIT NO. \_\_\_\_\_ ISSUED \_\_\_\_\_

JOB LOCATION 1164 Chelsea Ave.

LOT B G+H 4th Replat  
 (Subdivision or Legal Description)

ISSUED BY \_\_\_\_\_  
 (Building Official)

OWNER James McColley PHONE 592-5248

ADDRESS 712 Daggett Dr.

AGENT Kahle Builders PHONE \_\_\_\_\_

ADDRESS \_\_\_\_\_

USE:  Residential ( ) Commercial ( ) Industrial  
 Other \_\_\_\_\_

WORK:  New ( ) Addition ( ) Replacement ( ) Remodel

ESTIMATED COST = \$ 142,882.00

**ZONING INFORMATION**

District	Lot Dimensions	Area	Front Yard	Side Yard	Rear Yard
R-4	N/A	9242	25	0	15
Max Height	No. Pkg. Spaces	No. Lqg. Spaces	Max Cover	Petition or Appeal Required-Date	
45'	2		45%		

**WORK INFORMATION**

Building: Ground Floor Area 1541 sq. ft. Basement Floor Area \_\_\_\_\_ sq. ft.  
 Garage Floor Area 410 sq. ft. 2nd Floor Area \_\_\_\_\_ sq. ft. Other Porch 148 sq. ft.  
 Size: Length 55 Width 46' Stories 1 Height 20  
 Building Volume (for Demolition Permit) \_\_\_\_\_ cubic feet  
 Description of Work: New Home

	Base	Plus	Total
<input checked="" type="checkbox"/> Building	\$ <u>237.00</u>	\$ <u>34.00</u>	\$ <u>271.00</u>
<input checked="" type="checkbox"/> Electrical	\$ <u>75.00</u>	\$ <u>10.00</u>	\$ <u>85.00</u>
<input checked="" type="checkbox"/> Plumbing	\$ <u>9.00</u>	\$ <u>30.00</u>	\$ <u>39.00</u>
<input checked="" type="checkbox"/> Mechanical	\$ <u>18.00</u>	\$ <u>8.00</u>	\$ <u>26.00</u>
( ) Demolition	\$ _____	\$ _____	\$ _____
( ) Zoning	\$ _____	\$ _____	\$ _____
( ) Sign	\$ _____	\$ _____	\$ _____
<input checked="" type="checkbox"/> Water Tap	\$ <u>198.00</u>	\$ <u>5.00</u>	\$ <u>203.00</u>
<input checked="" type="checkbox"/> Sewer Tap	\$ <u>112.00</u>	\$ <u>60.00</u>	\$ <u>172.00</u>
<input type="checkbox"/> Temp-Water	\$ _____	\$ _____	\$ _____
<input type="checkbox"/> Temp-Elec.	\$ _____	\$ _____	\$ _____

Additional Plan Review: Structure \_\_\_\_\_ Hours \_\_\_\_\_  
 Electric \_\_\_\_\_ Hours \_\_\_\_\_

TOTAL FEES . . . . . \$ \_\_\_\_\_  
 Less Fees Paid . . . . . \$ \_\_\_\_\_  
 BALANCE DUE . . . . . \$ \_\_\_\_\_

**ELECTRICAL:** Contractor \_\_\_\_\_ Phone \_\_\_\_\_  
Address \_\_\_\_\_ ESTIMATED COST = \$ \_\_\_\_\_

Type of Work:  New  Service Change  Rewiring  Add'l Wiring TEMPORARY ELEC. REQUIRED -  Yes  No  
Size of Service 200 Underground  Overhead \_\_\_\_\_ Number of New Circuits 25

Description of Work: \_\_\_\_\_

**PLUMBING:** Contractor \_\_\_\_\_ Phone \_\_\_\_\_  
Address \_\_\_\_\_ ESTIMATED COST = \$ \_\_\_\_\_

WATER TAP REQUIRED -  Yes  No Size \_\_\_\_\_ Type of Pipe \_\_\_\_\_ Water Dist. Pipe \_\_\_\_\_

SANITARY SEWER TAP REQUIRED -  Yes  No Size \_\_\_\_\_ Type of Pipe \_\_\_\_\_ Dr. Waste Vt. Pipe \_\_\_\_\_

STREET SEWER TAP REQUIRED -  Yes  No Type of Pipe \_\_\_\_\_ STREET TO BE OPENED -  Yes  No  
Main Building Drain Size = \_\_\_\_\_ Main Vent Pipe Size = \_\_\_\_\_

**LIST NUMBER OF PLUMBING FIXTURES BELOW:**

Water Closets = 2 Bathtubs = 1 Showers = 1 Lavatories = 2 Kitchen Sinks = 1 Disposal = 1  
Clothes Washer = 1 Floor Drains = \_\_\_\_\_ Dishwasher = 1 Other \_\_\_\_\_ Total = 10

Description of Work: \_\_\_\_\_

**MECHANICAL:** Contractor \_\_\_\_\_ Phone \_\_\_\_\_  
Address \_\_\_\_\_ ESTIMATED COST = \$ \_\_\_\_\_

HEATING SYSTEM -  Forced Air  Gravity  Hot Water  Steam  Unit Heaters  Radiant  Baseboard

TYPE OF FUEL -  Electric  Natural Gas  Propane  Wood  Coal  Solar  Geothermal Other \_\_\_\_\_

NUMBER OF HEAT ZONES = \_\_\_\_\_ HOT WATER -  One (1) Pipe  Two (2) Pipes  Series Loop

ELECTRIC HEAT - Number of Circuits \_\_\_\_\_ Number of Furnaces \_\_\_\_\_ Number of Hot Air Runs \_\_\_\_\_

Number of Hot Water Radiators \_\_\_\_\_ Total Heat Loss \_\_\_\_\_ Rated Capacity of Furnace/Boiler \_\_\_\_\_

LOCATION OF HEATING UNITS -  Crawl Space  Floor Level  Attic  Suspended  Roof  Outside

Description of Work: \_\_\_\_\_

**DRAWINGS REQUIRED:** All applications must be accompanied by two (2) complete sets of Drawings including Site Plan, Foundation Plans, Floor Plans, Structural Framing Plans, Exterior Elevations, Section and Details, Stair Details, Electrical Layout, Plumbing Isometric, Heating Layout, etc. All Plans shall be drawn to scale, show all existing structure on the Site Plans, and show electric panel and furnace locations.

**READ AND SIGN BELOW:** The undersigned hereby makes application for a Permit for all work described herein and agree to complete the work in strict accordance with all applicable provisions of the current edition of the C.A.B.O. Building Code, the Napoleon Building and Zoning Codes, the Napoleon Engineering Department Rules and Regulations, Standard Specifications and other pertinent sections of the Napoleon Code of Ordinances.

Signature of Applicant \_\_\_\_\_ Date \_\_\_\_\_



CITY OF NAPOLEON WATER TAPPING PERMIT FORM

PERMIT #:

ISSUED:

JOB LOCATION: \_\_\_\_\_

SUBDIVISION NAME: \_\_\_\_\_ LOT #: \_\_\_\_\_

OWNER: Kahle Bldr.

ADDRESS: 1164 Chelsea

CONTRACTOR: \_\_\_\_\_ PHONE: \_\_\_\_\_

TAP SIZE: 1" X 1.5" \_\_\_\_\_ 2" \_\_\_\_\_ OTHER \_\_\_\_\_

AMOUNT PAID: \_\_\_\_\_ YOKE SIZE: \_\_\_\_\_

PLUMBING CONTRACTOR: \_\_\_\_\_ PH: \_\_\_\_\_

DATE OF TAP: 6-9-04 OLD TAP #: — NEW TAP #: 0433

SIZE AND KIND OF MAIN: 8" C-900

LOCATION OF MAIN: 6' EAST OF EAST CURB DEPTH OF MAIN: 5'

DIST FROM HYDRANT VALVE: 74' S of Hyd 489 DIST TO CURB STOP FROM CORP: 50'

1164

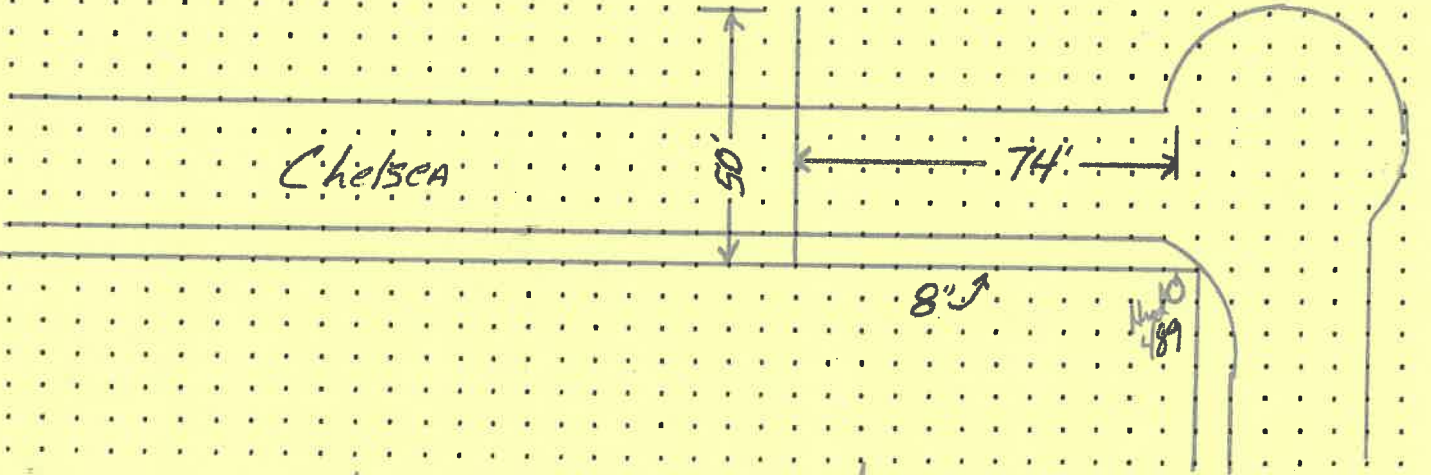

DATE APPROVED: Jan 12, 05

BY: Affrey C. Mantel



Illeg Chelised





City of Napoleon

Water Meter Yoke Release Form

THIS DOCUMENT ENTITLES THE HOLDER TO "ONE" WATER METER YOKE ASSEMBLY  
(Please pickup at City Operations Department 1775 Industrial Drive).

Permit #001954

Date Issued: 11-19-2003

Job Location: 1164 CHELSEA AVE

Owner: MCCOLLEY, JAMES

Address: 712 DAGGETT DR          NAPOLEON, OH 43545

Owner Phone: 419-592-5248

Contractor: KAHLE DESIGN & BLD

---

Address: 4615 ADAMS RIDGE RD          DEFIANCE, OH 43512

Phone: 419-497-4805

Water Tap Size      1"       1.5" \_\_\_\_\_      2" \_\_\_\_\_      Other \_\_\_\_\_

Water Meter Yoke Size      5/8"       3/4" \_\_\_\_\_      1" \_\_\_\_\_      Other \_\_\_\_\_

New Structure       Existing Structure \_\_\_\_\_      Lawn Meter \_\_\_\_\_

**WATER SERVICE LINE TO BE TYPE "K" COPPER OR "CTS" POLYETHELENE TUBING OF 1" MINIMUM SIZE.**

Backflow Device Required      Yes       No \_\_\_\_\_

Type of Backflow Required: DEUFA

---

Water Meter Yoke Installation is subject to the following conditions

- 1.) Must be located in an accessible area.
- 2.) Must be in an area which is not subject to freezing temperatures.
- 3.) Must be at least 18" above floor level (no crawl space installations).
- 4.) Must comply with minimum mounting requirements (drawing available)

Issued By \_\_\_\_\_ Received By \_\_\_\_\_

1 Copy to: Building Dept, Water Dept, and Utilities Dept



City of Napoleon

Electric Meter Base Release Form

THIS DOCUMENT ENTITLES THE HOLDER TO "ONE" ELECTRIC METER BASE.

(Please pickup at the City Operations Garage 1775 Industrial Drive).

Permit#001954

Date Issued: 11-19-2003

Job Location: 1164 CHELSEA AVE

Work Description: NEW HOME

Owner: MCCOLLEY, JAMES

Address: 712 DAGGETT DR      NAPOLEON, OH 43545

Owner Phone: 419-592-5248

Contractor: KAHLE DESIGN & BLD

Address: 4615 ADAMS RIDGE RD      DEFIANCE, OH      43512

Contractor Phone: 419-497-4805

Electric Service Upgrade \_\_\_\_\_ New Service Installation   X  

Industrial \_\_\_\_\_ Commercial \_\_\_\_\_ Residential   X   1 Phase   X   3 Phase \_\_\_\_\_

Size of Service 100 Amp \_\_\_\_\_ 150 Amp \_\_\_\_\_ 200 Amp   X   400 Amp \_\_\_\_\_ Other \_\_\_\_\_

Hub Size - 1 1/4" \_\_\_\_\_ 1 1/2" \_\_\_\_\_ 2" \_\_\_\_\_

Desired Voltage 120/240   X   Other \_\_\_\_\_

Underground Service   X   Overhead Service \_\_\_\_\_

Date Completed: \_\_\_\_\_ Approved By: \_\_\_\_\_

Old Meter Number: \_\_\_\_\_ New Meter Number \_\_\_\_\_

Comments: \_\_\_\_\_  
\_\_\_\_\_  
\_\_\_\_\_

